

SKID CONTROL SENSOR REPLACEMENT

32090-01

HINT:

Replace the RH side by the same procedure with LH side.

1. REMOVE REAR WHEEL

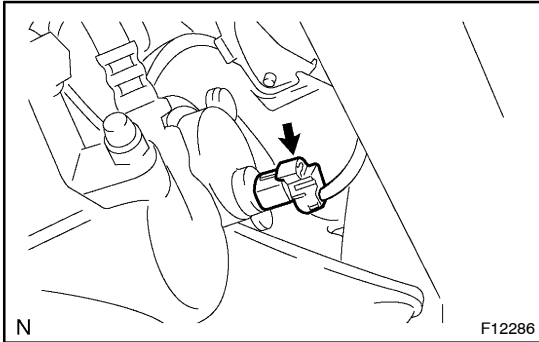

2. SEPARATE SKID CONTROL SENSOR WIRE

- (a) Separate the connector from the skid control sensor.

3. REMOVE REAR DISC BRAKE CALIPER ASSY, LH (See page 30-28)

4. REMOVE REAR DISC

(See page 33-13)

5. REMOVE REAR AXLE HUB & BEARING ASSY LH

(See page 30-28)

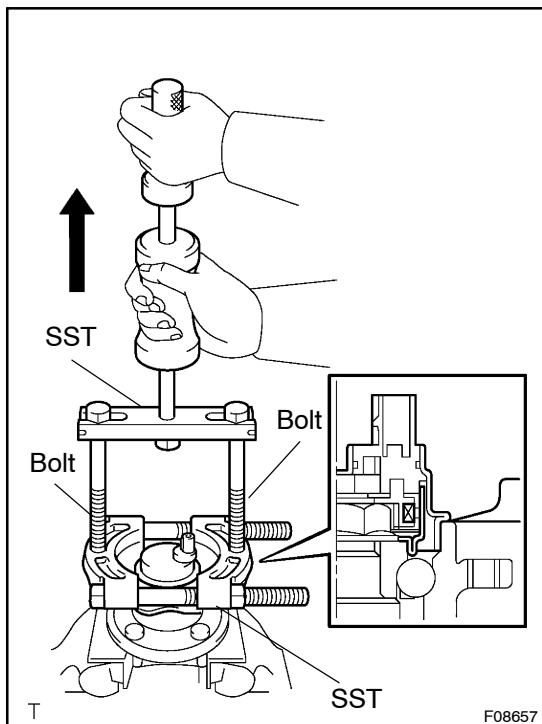

6. REMOVE SKID CONTROL SENSOR

- (a) Mount the rear axle hub in a soft jaw vise.

NOTICE:

Replace the axle hub assembly if it is dropped or a strong shock is given to it.

- (b) Using a pin punch and hammer, drive out the 2 pins and remove the 2 attachments from SST.

- (c) Using SST and 2 bolts (Diameter: 12 mm, pitch: 1.5 mm), remove the skid control sensor from the rear axle hub.

SST 09520-00031 (09520-00040), 09521-00020, 09950-00020

NOTICE:

- If a damage is inflicted to the sensor rotor, replace the axle hub assembly.
- Do not scratch the contacting surface of axle hub and speed sensor.

7. INSTALL SKID CONTROL SENSOR

- (a) Clean the contacting surface of the axle hub and a new skid control sensor.

NOTICE:

Do not stick any foreign matter to the sensor rotor.

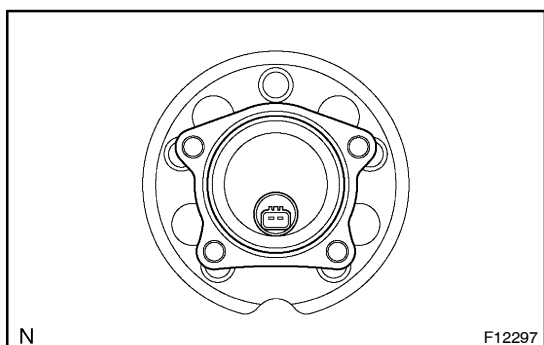

- (b) Place the speed sensor on the axle hub so that the connector makes the most downward position under the on vehicle condition.

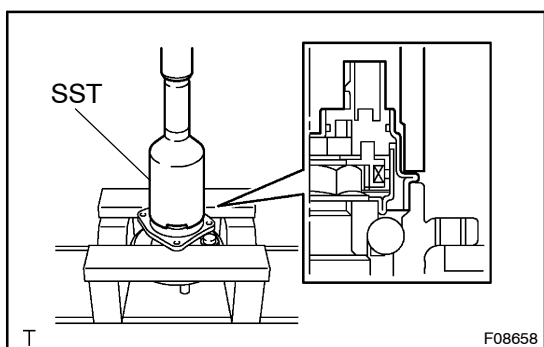

- (c) Using SST and a press, install the skid control sensor to the axle hub.

SST 09214-76011

NOTICE:

- Do not tap the skid control sensor with a hammer directly.
- Check that there should be no foreign matter on the skid control sensor detection portion.
- Press in the skid control sensor straight and slowly.

8. INSTALL REAR AXLE HUB & BEARING ASSY LH

(See page 30-28)

9. INSTALL REAR DISC

(See page 33-13)

10. INSTALL REAR DISC BRAKE CALIPER ASSY, LH (See page 30-28)

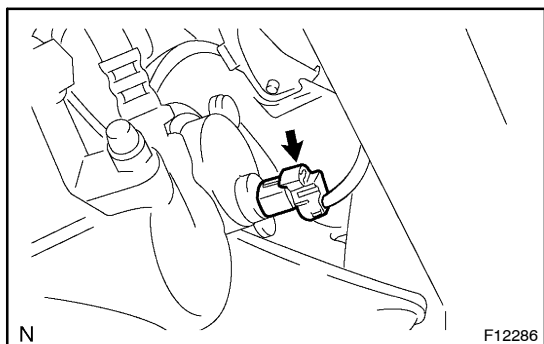

11. CONNECT SKID CONTROL SENSOR WIRE

- (a) Connect the connector to the skid control sensor.

12. INSTALL REAR WHEEL

Torque: 103 N·m (1,050 kgf·cm, 76 ft·lbf)

13. INSPECT AND ADJUST REAR WHEEL ALIGNMENT (See page 27-3)

14. CHECK ABS SPEED SENSOR SIGNAL (See page 05-295)